



低压全封闭母线系统

BUSBAR SYSTEM PRODUCT MANUAL



TEL 0577-6176 7777

地址：浙江省乐清经济开发区纬三路 198 号
电话：0577-6272 7447
传真：0577-6272 8447

寺崎科技有限公司
SIQI TECHNOLOGY CO.,LTD.

Http: //www.siqi.cc www.monqe.com
E-mail: siqi@siqi.cc

寺崎科技有限公司
SIQI TECHNOLOGY CO.,LTD.



SIQI

TECHNOLOGY CO.,LTD.



寺崎科技有限公司原浙江寺崎电气有限公司成立于 2001 年 4 月 19 日，座落在乐清经济开发区纬三路，占地面积 6000m²，建筑面积 15000m²。本公司现有员工 180 多人、高级工程师 3 人、工程师 10 人，各类质量人员 12 人，高级管理人员 6 人，注册资金 5000 万元，年产值近亿元。本公司是以生产：电气火灾监控系统、消防设备电源监控系统、电力仪表、双电源自动转换开关、塑料外壳式断路器、小型断路器、漏电断路器、控制与保护开关电器、电涌保护器、万能式断路器、负荷隔离开关、微机综合保护装置等产品的国家高新技术企业。

自建厂以来，一直贯彻“科技、创新、奉献”的企业理念，全面发展、追求卓越，在新产品开发、产品品质提高、服务质量完善、人力资源等投入方面，不遗余力，锐意进取。始终将企业自身的利益与社会的需求紧密结合相连，积极实践“为客户创造价值，为员工创造机会，为社会创造效益”的企业宗旨，为社会提供一流的产品和优质的服务。在日趋激烈的市场竞争中，寺崎的品牌知名度、美誉度及市场占有率，居全国同行业的前列，并通过了 ISO9001 质量体系认证、CCC、CCCF 产品强制认证和 CB 认证，拥有多个外观及实用新型专利及二项发明专利，产品由中国人民保险公司承保。

目前，公司在国内已建立了 30 余家代理商，300 多个销网点的经销网络及完善的售后服务体系，更好地为消费者服务，并持续与全国各级经销商团结奋进，风雨同舟，共同发展，开创行业新天地，谱写寺崎新篇章。

企业简介

INTRODUCTION

Siqi Technology Co.,Ltd. was founded in 2001, it is a modern electric enterprise specializing in producing automatic transfer switch, load breaking switch and manual changeover switch, mini circuit breaker, residual current circuit breaker, moulded case circuit breaker, universal circuit breaker, surge protective device, AC contactor, control and protective switching device, digital panel meter. Since founded Siqi has always abided by enterprise idea "Science & technology, Innovation, Contribution", to pursue overall development and excellence, improve quality, perfect service quality and strengthen human resource, it has combined enterprise self benefits and social needs closely all the time, to supply first rank products and excellent service. In the sharp market competition, public recognition, good reputation and market occupancy of Siqi brand rank the first place, and Siqi has obtained ISO9001、ISO14001,CCC certification and its all goods are insured by PICC of China, meanwhile, gained many international certificates including CE,CB. The company has established 35-old agents, more than 300 sales networks points as well as perfect after-sale service system in the China. to supply better service for customers.

Our products are sold to over 30 countries and areas including East Europe, West Europe, Korea, South America, Middle East, Southeast Asia and Africa. Since 2007, we have established close cooperation of production and technology with one World fortune 500 enterprises- High and Low Voltage Electrical Enterprises of Korea Hyundai Heavy Industries. we have expanded the international market entirely.





产品目录

CATALOGUE

母线系统介绍

Busbar System

HYCR17系列熔断器式隔离开关
HYCR17 Series fuse type isolation switch

01-05

HYCR21系列条型熔断器式隔离开关
HYCR21 Series fuse type isolation switch

05-08

母线系统接线附件
Wiring accessory for busbar system

09-11

HYCBA系列母线转接器
HYCBA Series bus adapter

12-16

全封闭低压母线系统，是低压配电系统技术发展的趋势。因其安装便捷高效，可维护性高以及安全可靠等优点，必将成为中高端低压配电系统的首选接线方案。

Fully enclosed low voltage bus system is the ternd of low voltage distribution system.Become the preferred scheme for high-end low-voltage distribution system because of its advantages on convenient installation, high efficiency, high maintainability and reliability.

母线系统介绍 Busbar System

寺崎母线系统是母线间距标准化的系统，应用于低压供配电开关设备中，使母线起到即导电又能支持电气元件的作用。系统分为60mm、185mm系统。

SHIQI bus system is a standardized systems.of bus bar 。which is used in low-voltage power supply and distribution equipment.The system is divided into 60 and 185mm systems.

产品特点 Bus System Characteristics

电气元件直接挂接在母线上
母线不打孔连接
节省安装空间
安装快捷、方便
减少布线，易维护
便于更换元件及增加回路

Electrical components can be directly installed to the bus bar
Busbar connection
Save installation space
Quick and convenient installation
Less wring , easy Maintenance
Easy to replace components and increase the circuit

产品概述 Product overview

系统特点

在60mm母线系统中，利用矩形和异型母线横截面积不同，实现了电流强度等级的最佳分配，安全可靠性强。
熔断器管座的座（母线式）
在60mm系统上可安装3相的条型DO-和D-熔断器管座（母线式）。带触摸保护的SNHG-熔断器座（母线式）最大尺寸为2.特殊的SNHG-熔断器座加装快熔熔断器可保护半导体元件。

System advantages

60mm bus system because of the different of bus cross section area of of rectangles and shape, realize the optimal allocation of current intensity level, high safety and reliability.
Fuse tube seat (bus)
3 phase DO-and D-fuse socket (bus) could be installed on 60mm bus system.The SNHG-fuse holder (busbar type) with touch protection, the largestsiz is 2.Special SNHG-fuse seat is equipped with fast fuse, which can protect the semiconductor component.

技术

全新的60mm母线系统转接技术：母线转换器可安全接挂在 $12 \times 5\text{mm} \sim 30 \times 10\text{mm}$ ，和2T异型母线上，系统最大电流2500A。以其双层结构可更安全地应用在新的领域。在更换开关元件时，无需断电。

Technology

The last 60mm bus system technology: bus apater safely hook up $12 \times 5\text{mm} \sim 30 \times 10\text{mm}$, and 2T special bus.Maximum current is 2500A with its two-tier structure can be moer securely in the new field. When replacing the switch, no power.

连接技术

- 通用导线连接夹和展开式连接夹或接线板可把最大300m²的导线连接在不打孔母线上，而且不用截断导线即可使用接线板连接两个母线系统。展开式连接夹利用超强度卡接技术实现圆形和扁平导线的快速连接。母线加长连接夹可安全方便地实现母线系统的扩展。
- 尺寸00~3的SNHD-熔断式负荷隔离开关（60mm 母线式）可变换上端和线段接线。外加弹力接触片可实现与母线系统的简单而安全的接触。
- 尺寸00~3的SNHT-条型熔断器式负荷隔离开关可与185mm母线系统上的所有组件配套使用。全新设计的结构保证了SNHT条型熔断器式负荷隔离开关在不打孔母线上便捷地安装。可变换上端或下端接线。
- 量身定制的系统技术
根据客户需要，公司可提供最佳的母线系统选型方案。

Connection technology

- Universal wire connection clamps and a connection clamps or strips of maximum 300mm² can be connected without drilling on the bus, and can be used without truncating the wire terminal blocks for connecting two Busbar system. Expansion connecting clamp using super card technology for round and flat wire quick connect. Longer bus connecting clamp can be safe and convenient to bus system extensions.
- 00~3 SNHD- fuse switch disconnecter (60mm bus system) can change the upper and lineconnection. Plus the elastic contact chip enables easy and secure contact with the bus system.
- 00~3 SNHT fuse load disconnecter can be used with all components of 185mm on the bus system. New structure ensures the SNHT bar fuse load disconnectors are easily installed on the unpunched bus. Convertible wiring.
- Customer's system technology
System could according to customer's requirement, SUNAI can provide the best bus system.

安装方便快捷 Easy and quick installation

通过母线转接器可以把不同的低压开关元件直接挂接在母线上。导线连接夹和接线板可以方便灵活地把导线或母线连接在不打孔的母线上。

Bus adapter directly hook on different low-voltage switching devices on the bus. Wire connections and wiring plate makes it easy to wire or bus connection on the bus without drilling.



HYCR17系列熔断器式隔离开关 HYCR17 Series fuse type isolation switch

适用范围 Application range

HYCR17系列熔断器式隔离开关适用于交流50（60Hz）,额定电压至690V, 额定发热电流至630A, 作为电源开关、应急开关、并作为电路的过载和短路保护之用。
本产品符合GB14048.3、IEC60947.3、EN60947.3标准。

HYCR17 series fuse disconnecter is suitable for AC 50 (60Hz), rated voltage up to 690V, rated heating current to 630A, as power switch, emergency switch, and as circuit overload and short circuit protection.

This product complies with GB14048.3, IEC60947.3, EN60947.3 standards.

结构特点 Structural features

HYCR17系列熔断器式隔离开关是三极为一体,承载带电部件的基座采用高强度的玻璃纤维聚酯材料制成, 镀银的熔断器触刀座和配用NH(RT16)熔断体相组合,保证了产品的能量损耗少、工作温度低、分断能力高。

本系列熔断器式隔离开关的安装方式为固定式安装。

The HYCR17 series fuse disconnecter is a three-in-one unit. The base carrying the live parts is made of high-strength glass fiber polyester material, and the silver-plated fuse seat is combined with NH(RT16) fuse. The product has low energy loss, low working temperature and high breaking capacity.

This series of fuse disconnecters is installed in a fixed installation.

型号含义 Model meaning

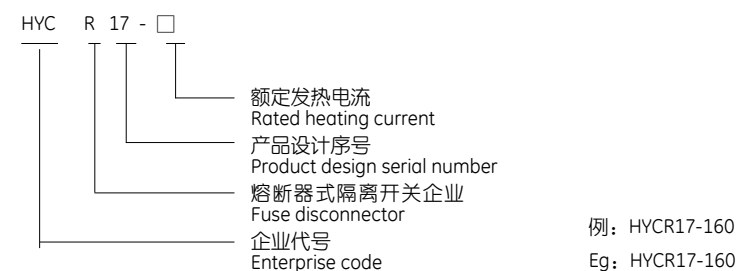

使用环境 Use environment

- 1.周围空气温度不超过+40℃, 24小时平均值不超过+35℃, 周围空气温度的下限值不低于-5℃。
- 2.开关安装的地点海拔不超过2000m。
- 3.安装的空气相对湿度在最高温度+40℃不超过50%, 在较低的温度下可允许有较高的相对湿度, 最湿热的平均最低温度不超过+25℃,该月的月平均最大相对湿度不超过90%。

1. The ambient air temperature does not exceed +40° C, the 24-hour average does not exceed +35° C, the lower limit of ambient air temperature is not lower than -5° C.
- 2.The location where the switch is installed does not exceed 2000m.
- 3.The relative humidity of the installed air is not more than 50% at the maximum temperature of +40° C. At lower temperatures, higher relative humidity is allowed. The average minimum temperature of the hottest heat does not exceed +25° C. The monthly average maximum relative of the month is relatively high. The humidity does not exceed 90%.

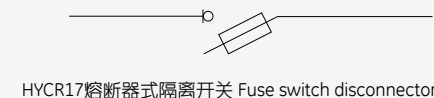

HYCR17熔断器式隔离开关 Fuse switch disconnecter

功能 Function

HYCR17熔断器式隔离开关具备下列功能:

HYCR17 Fuse switch disconnecter has following functions:

- 电路的负载切换。该类型熔断器工作的速度和分断能力, 与操作者的具体操作情况有关。
 - 熔丝闸片构成了熔断器的动触头。
 - 熔丝安装在熔断器底座里。
 - 通过操作手柄, 熔断器座能够操作主动触头。
 - 当熔断器底座处于断开位置(OFF)时, 可以用触点实现指示。
 - 借助DIN刀片型工业熔丝(NH), 能够提供配电电路的短路或过载保护。
- The load change over. The work speed and breaking capacity of the fuse is associated with the specific operation situation of the operator.
 - Fuse brake piece form the dynamic contact of the fuse.
 - Fuse is installed in the fuse base.
 - By manipulating the handle, the fuse base can operate the main active contact.
 - When the fuse base is in the OFF position(OFF), contacts can indicate information.
 - With DIN type blade industry fuse (NH), it can provide power distribution circuit with short circuit or overload protection.

控件 Control

借助下列元件, 可控制主动触头:

- HYCR17熔断器底座上的旋转面盖

当熔断器式隔离开关处于断开位置时, 熔断器座组件能够保证可视化的隔离断点。

With the help of the following components,main contact can be controlled .

- Rotating cover on the base of HYCR17 fuse .

When the fuse type isolating switch in the off position, the parts on the base of fuse ensure the visible isolation breakpoints.

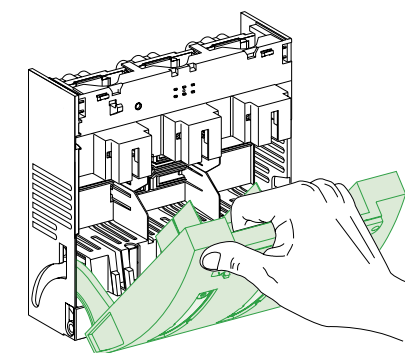

锁定 Lock

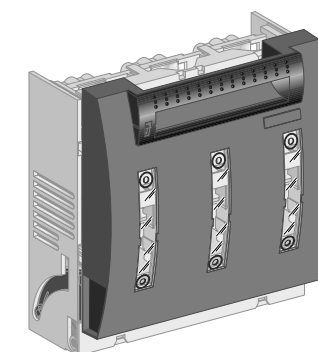

铅封件锁定
用于HYCR17-100至HYCR17-630

Seal retainer lock
Used from HYCR17-100 to HYCR17-630

将设备锁定在断开(OFF) 位置，能够
确保其隔离等级符合IEC 60947-3标准

Lock device in the disconnect (OFF) position, to ensure that the
level of isolation is in accordance with IEC 60947-3 standard

型号 Model	功能 Function	工具 Instrument	附件 Accessory
HYCR17-100	接通(ON)或断开(OFF)位置的 设备锁定 The lock in ON (ON) or OFF (OFF) position	铅封件 Seal	内置式 Built-in type
HYCR17-160			
HYCR17-250~630			

HYCR17熔断器，熔断器底座组件既可控制设备，又可罩住熔丝。

对于熔断器式隔离开关HYCR17-100至HYCR17-630，熔断器底座上的旋转面盖组件包括三条并排熔丝；

HYCR17 fuse, fuse base components can control equipment, but also can cover the fuse.

For fuse type isolating switch from HYCR17-100 to HYCR17-630, the rotating cover components include three side by side fuse at the fuse base.

熔断器座 Fuse base

HYCR17熔断器式隔离开关和熔丝（NH）的兼容性

HYCR17 fuse type isolating switch and fuse (NH) compatibility

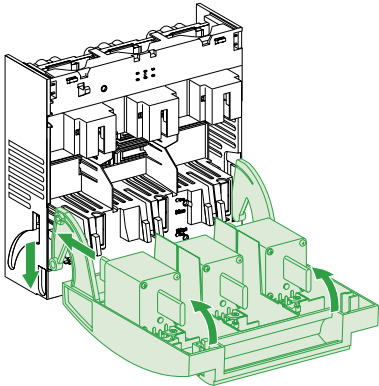

HYCR17-100至HYCR17-630
盖内的熔断器座组件

HYCR17-100 to HYCR17-630
Inside the cover fuse base components

DIN熔丝的型号 DIN fuse type	NH000	NH00	NH1	NH2	NH3
HYCR17-100	■	-	-	-	-
HYCR17-160	■	■	-	-	-
HYCR17-250	-	-	■	-	-
HYCR17-400	-	-	-	■	-
HYCR17-630	-	-	-	-	■

熔丝的插入和拆除 Fuse insertion and removal

熔断器前端后侧的夹具能够固定熔丝；因此无需触碰熔丝，即可将其拆除。

Fixture in the front and back side of the fuse can keep fuse fixed; Therefore there is no need to touch the fuse, it can be removed.

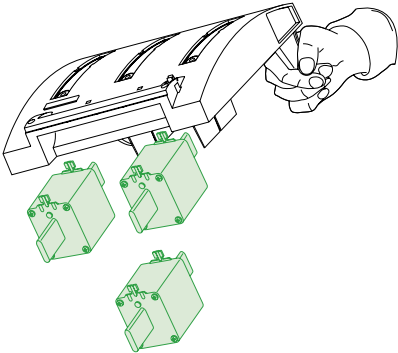

HYCR17-100至HYCR17-630
HYCR17-100 to HYCR17-630

技术参数 Technical parameters

产品型号 Product model	约定发热电流 (Ith) Conventional heating current (Ith)	额定电压(V) Rated voltage (V)	频率(Hz) Frequency (Hz)	额定接通能力(Iar. m.s) Rated turn-on capability (Ar.m.s)	额定分断能力(Iar. m.s) Rated breaking capacity (Ar.m.s)	额定限制短路电流 (r.m.s) Rated limit short-circuit current (r.m.s)	配用熔断体 Match with Fuse
HYCR17-100	100	380/660	50/60	10Ie	8Ie	50kA	RT16-000 (NT000)
HYCR17-160	160						RT16-00 (NT00)
HYCR17-250	250						RT16-1 (NT1)
HYCR17-400	400						RT16-2 (NT2)
HYCR17-630	630						RT16-3 (NT3)

外形尺寸及安装尺寸图 dimensions and installation dimensions

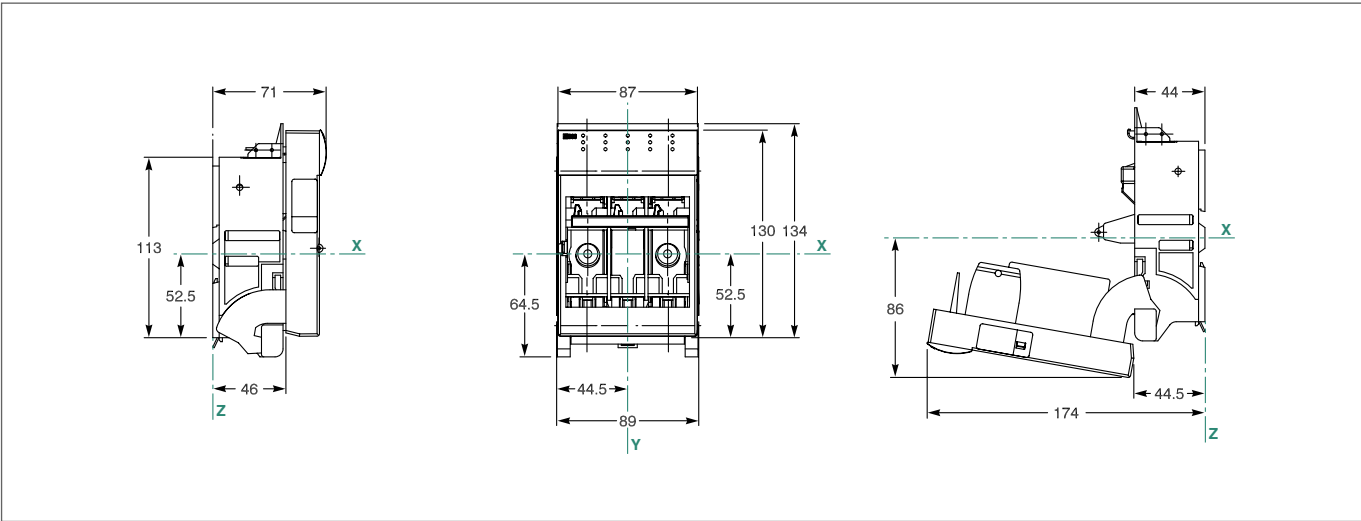

HYCR21系列条型熔断器式隔离开关 HYCR21 Series of strip fuse type isolation switches

适用范围 Application range

HYCR21系列条形熔断器式隔离开关适用于交流50 (60Hz),额定电压至690V, 额定发热电流至630A,100以及185母线系统的配电装电路, 作为电源开关、应急开关、并作为电路的过载和短路保护之用。

本产品符合GB14048.3、IEC60947.3标准。

HYCR21 series fuse switch disconnecter is suitable for AC 50 (60Hz), rated voltage to 690V, rated thermal current to 630A, 100 and 185 busbar system power distribution circuit. As power switch, emergency switch, and as a circuit for overload and short circuit protection.

This product complies with GB14048.3 and IEC60947.3 standards.

结构特点 Structural features

HYCR21系列条形熔断器式隔离开关安装在100mm或185母线系统上,具有上下进出线对调,可独立分断,亦可三相分断,首创与电流互感器一体化;可插熔断体做动触头用,亦可直接带刀片做隔离开关用。将3只纵向排列的单极式熔断器隔离开关融于一体。每相的一个触刀座与一个三相的母线系统的一相联接,出现可选配各种电缆接线端子。

承载带电部件的底座采用高强度的玻璃纤维聚酯材料制成, 镀银的熔断器触刀座和连接母排紧密结合, 保证了产品能量损耗小, 工作温度低分断能力高。出线为标准的螺栓形式, 也可加装电缆接线端子。外壳为旋转锁扣固定, 易于方便拆卸。

HYCR21系列条形熔断器式隔离开关的安装方式分螺丝固定安装和挂钩固定安装两种。挂钩固定安装, 母线排无需冲孔, 使安装更方便、灵活、可靠。

HYCR21 series fuse switch disconnecter is installed on 100mm or 185 busbar system. It has upper and lower in and out line swap, it can be separated independently, or can be separated by three phases. The first integration with current transformer. It can be inserted into fuse-connected as moving contact. It can also be used as a disconnecter with a blade. Combine three longitudinally arranged single-pole fuse switch disconnectors in one. One of the tool holders of each phase is coupled to one of the three-phase busbar systems, and various cable terminals are available.

The base carrying the live parts is made of high-strength glass fiber polyester material. The silver-plated fuse seat and the connecting busbar are tightly combined to ensure low energy loss and high working temperature and high breaking capacity. The out lines are in the form of standard bolts and cable terminations can also be added. The outer case is fixed by a rotary lock for easy removal.

HYCR21 series fuse switch disconnecter is installed in two ways: screw mounting and hook mounting. The hook is fixedly installed, and the busbar row does not need to be punched, which makes the installation more convenient, flexible and reliable.

型号含义 Model meaning

HYC	R	21	-	□	□	□

例: HYCR21-160L/100, HYCR21-160L/185

Eg:HYCR21-160L/100, HYCR21-160L/185

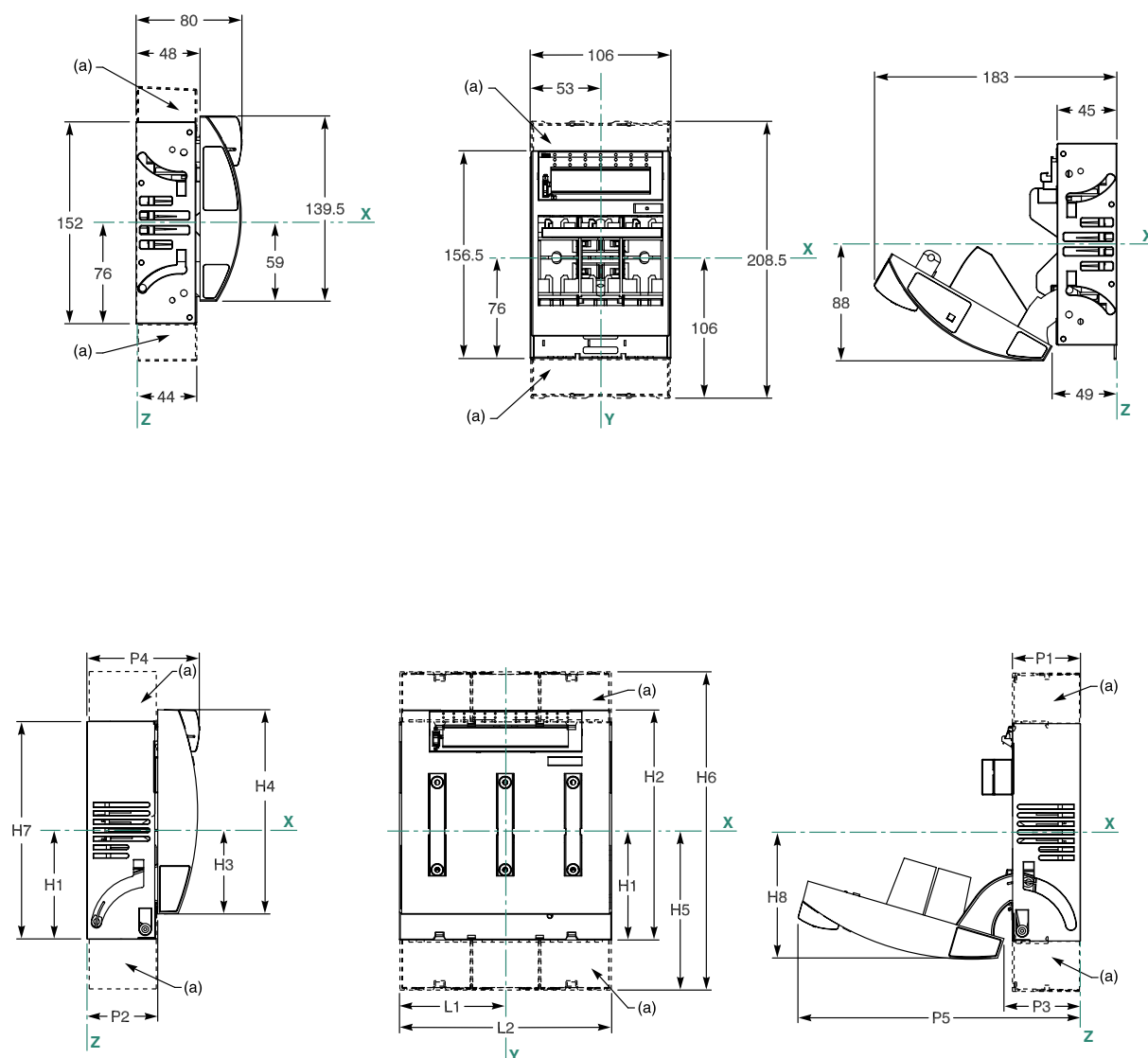

技术参数 Technical Parameters

产品型号 Product model	约定发热电流 (I _{th}) Conventional thermal current	工作电压下额定电 流(I _e) Rated current at operating voltage 500V/ AC-23B 690V/ AC-22B	频率(Hz) Frequency	额定接通 能力(A _{r.m.s}) Rated connection capacity	额定分断 能力(A _{r.m.s}) Rated breaking capacity	额定限制短 路电流(I _{r.m.s}) Rated limited short-circuit current	配用 熔断体 Match with Fuse	备 注 Remark
HYCR21-160L/100								100系统 三极同时操作 100system 3 poles simultaneous operation
HYCR21-160L/185	160	160					RT16-00 (NT00)	185系统 三极同时操作 185system 3 poles simultaneous operation
HYCR21-160S/185								185系统 单极独立操作 185system single pole independent operation
HYCR21-250L/185								185系统 三极同时操作 185system 3 poles simultaneous operation
HYCR21-250S/185	250	250	50/60	10I _e	8I _e	50kA	RT16-1 (NT1)	185系统 单极独立操作 185system 3 poles independent operation
HYCR21-400L/185								185系统 三极同时操作 185system 3 poles independent operation
HYCR21-400S/185	400	400					RT16-3 (NT2)	185系统 单极独立操作 185system 3 poles independent operation
HYCR21-630L/185								185系统 三极同时操作 185system 3 poles independent operation
HYCR21-630S/185	630	630					RT16-3 (NT3)	185系统 单极独立操作 185system 3 poles independent operation

使用环境 Use environment

- 1.周围空气温度不超过+40℃，24小时平均值不超过+35℃，周围空气温度的下限值不低于-5℃。
 - 2.开关安装的地点海拔不超过2000m。
 - 3.安装的空气相对湿度在最高温度+40℃不超过50%，在较低的温度下可允许有较高的相对湿度，最湿热的平均最低温度不超过+25℃,该月的月平均最大相对湿度不超过90%。
1. The ambient air temperature does not exceed +40° C, the 24-hour average does not exceed +35° C, the lower limit of ambient air temperature is not lower than -5° C.
- 2.The location where the switch is installed does not exceed 2000m.
- 3.The relative humidity of the installed air is not more than 50% at the maximum temperature of +40 ° C. At lower temperatures, higher relative humidity is allowed. The average minimum temperature of the hottest heat does not exceed +25 ° C. The monthly average maximum relative of the month is relatively high. The humidity does not exceed 90%.

外形尺寸及安装尺寸图 Dimensions and installation dimensions

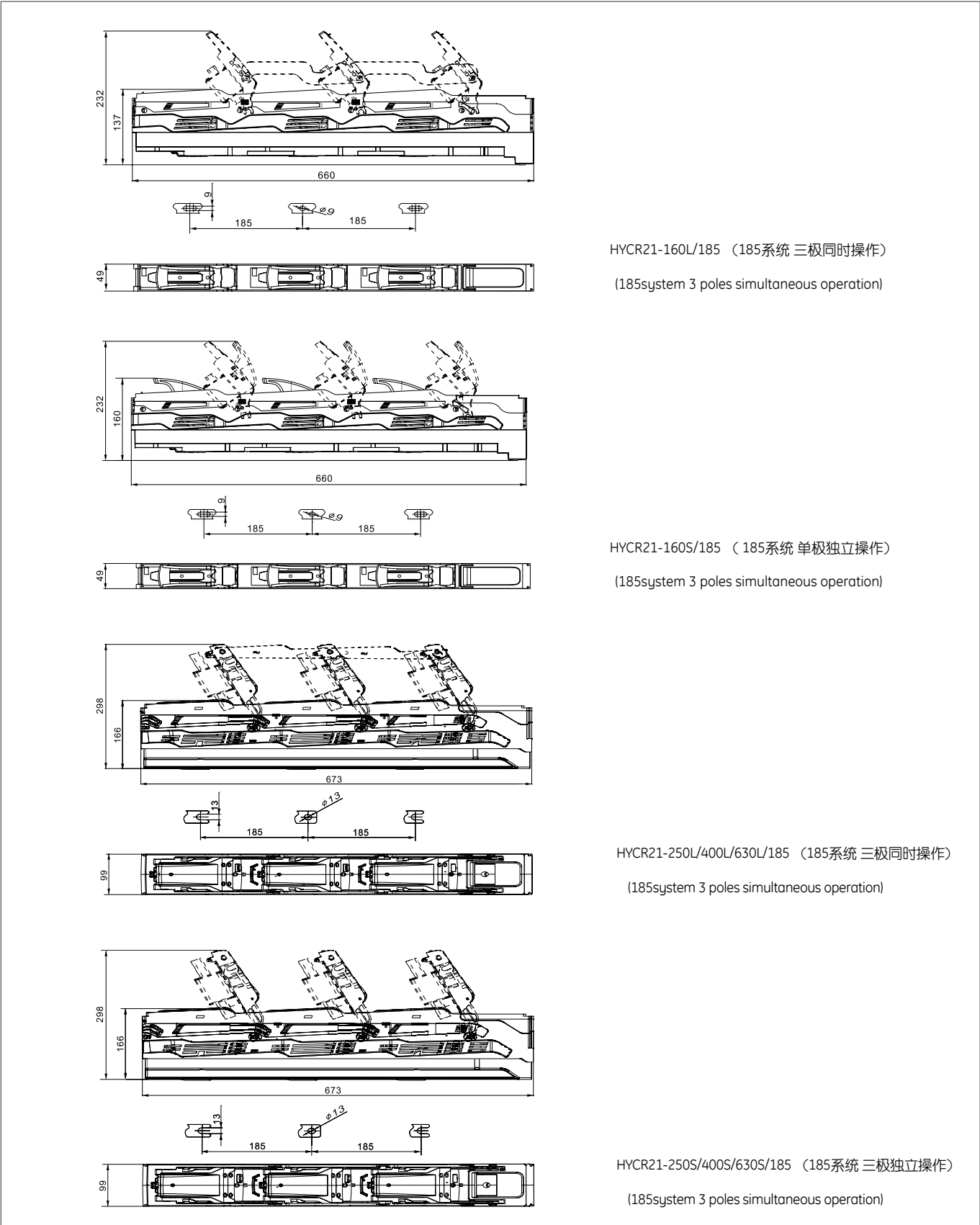
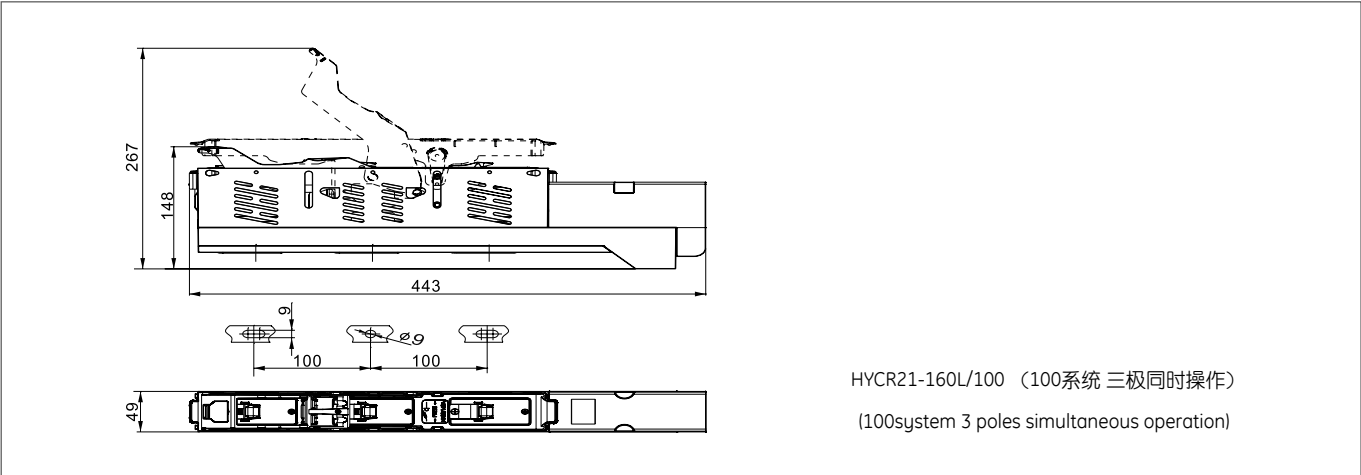



母线系统接线附件
Wiring accessory for busbar system

接线板 适用12~30 × 5.10mm， 2T异型母线， 3线，带盖罩
Teminal bolock is suitable for 12~30 × 5.10mm， 2T special bus， 3phase， with covers



连接 Connection	外型尺寸 Dimension W × H(mm)	适用电流(最大) Applicable current(max)	订货号 Reference
Cu和Al*95-185mm²	135 × 200	460A	HYC01199
Cu和Al*120-300mm²	135 × 200	560A	HYC01754
适用最大32 × 20**的多层 软铜排	135 × 200	800A	HYC01753

*使用铝导线连接时需要保护。**注意连接夹的最小开口空间。
*Maintain when using aluminum wire connection.**Note the minimum opening space of the connection clip

接线组件 适用12~30 × 5.10mm， 2T异型母线， 3线，带盖罩
Connection component is suitable for 12~30 × 5.10mm， 2T special bus， 3phase， with covers



连接 Connection	外型尺寸 Dimension W × H(mm)	适用电流(最大) Applicable current(max)	订货号 Reference
Cu和Al*120-300mm²	153 × 184	560A	HYC01537
适用最大32 × 20的矩形母线	153 × 184	800A	HYC01538

*使用铝导线连接时需要维护
*Maintain when using aluminum wire connection

接线组件 适用12~30 × 5.10mm， 2T异型母线， 4线（N线左），带盖罩
Connection component is suitable for 12~30 × 5.10mm， 2T special bus， 4phase（N ine left）， with covers



连接 Connection	外型尺寸 Dimension W × H(mm)	适用电流(最大) Applicable current(max)	订货号 Reference
Cu和Al*120-300mm²	204 × 224	560A	HYC01147
适用最大32 × 20的矩形母线	204 × 224	800A	HYC01162

*使用铝导线连接时需要维护
*Maintain when using aluminum wire connection

接线组件 适用12~30 × 5.10mm， 2T异型母线， 4线（N线左），带盖罩
Connection component is suitable for 12~30 × 5.10mm， 2T special bus， 4phase（N ine left）， with covers



连接 Connection	外型尺寸 Dimension W × H(mm)	适用电流(最大) Applicable current(max)	订货号 Reference
Cu和Al*120-300mm²	204 × 224	560A	HYC01148
适用最大32 × 20的矩形母线	204 × 224	800A	HYC01163

*使用铝导线连接时需要维护
*Maintain when using aluminum wire connection

母线支架 Busbar stand

功能

配电箱内铜排支撑架
通过螺钉与配电柜底板固定连接

Function

copper bat stand in the power distribution ark
Fixed connection through the screw and power distribution ark bottom platen



HYC01601



HYC01508



HYC01357

PE/N-母线架/通用母线（60mm）

PE/N-busbar frame/unversal busbar frame（60mm）

结构 Stucture	母线 Busbar	订货号 Reference
1线PE/N母线架，可单独安装 A line PE/N busstand， can beinstalled separately	12， 20， 30 × 5， 10	HYC01601
3线带内置安装螺钉孔,线与线组合 3wire， with ter mounting screw holes	12， 15， 20， 25， 30 × 5， 10	HYC01508
4线带内置安装螺钉孔 4wire， with ter mounting screw holes	12， 15， 20， 25， 30 × 5， 10	HYC01357

标准铜母线，矩形母线，镀锡

Standard copper busbar， rectangular bus bar， tinned

尺寸 Dimension H × W(cm)	长度 Length(m)	截面积 Sectional area(mm²)	订货号 Reference
12 × 5	2.4	60	HYC01618
15 × 5	2.4	75	HYC01619
20 × 5	2.4	100	HYC01620
25 × 5	2.4	125	HYC01621
30 × 5	2.4	150	HYC01622
12 × 10	2.4	120	HYC01623
15 × 10	2.4	150	HYC01624
20 × 10	2.4	200	HYC01625
25 × 10	2.4	250	HYC01626
30 × 10	2.4	300	HYC01627
40 × 6	2.4	240	HYC01630
40 × 8	2.4	320	HYC01632
40 × 10	2.4	400	HYC01634
50 × 8	2.4	400	HYC01640
50 × 10	2.4	500	HYC01642



母线护套

Bus cover



结构
Stucture

订货号
Reference

适用12-30×5的矩形母线，长1.1m
Applicable to 12×30×5 rectangular busbar, length 1.1m

HYC01244

末端盖，封盖母线末端

End panel, capping bus end



HYC01026



HYC01320



HYC01136



HYC01025



HYC01554

结构
Stucture

订货号
Reference

3线盖板支架，两只一组与HYC01025组合使用
3-wire cover support, two groups combined with HYC01025

HYC01026

3线盖板支架，两只一组与HYC01025组合使用
3-wire cover support, two groups combined with HYC01025

HYC01320

3线盖板支架，一左一右与HYC01554组合使用
3-wire cover support, one left and one right combined with HYC01554

HYC01136

3线盖板支架，两只一组与HYC01026组合使用
3-wire cover support, two groups combined with HYC01026

HYC01025

3线盖板支架，一左一右与HYC01136组合使用
3-wire cover support, one left and one right combined with HYC01136

HYC01554

HYCBA系列母线转接器

HYCBA Series bus adapter

适用范围 Application range

本公司生产的HYCBA系列母线转接器适用于交流50(60Hz),额定电压至690V, 额定发热电流630A的配电电路系统中,与断路器配套使用,将电器设备直接安装在母线系统上的过渡部件。广泛应用于箱变,电缆分支箱等配电设施。

The HYCBA series bus adapters produced by our company are suitable for AC 50 (60Hz), rated voltage up to 690V, rated heating current 630A in the distribution circuit system, used with circuit breakers, and the electrical equipment is directly installed on the busbar system. Transition parts. Widely used in box transformers, cable branch boxes and other power distribution facilities.

结构特点 Structural features

HYCBA系列母线转接器为挂钩式固定安装。挂钩固定安装，母线排无需冲孔，使安装更方便、灵活、可靠。亦可实现上进下出,以及下进上出的对调,并方便于断路器的更换与检修。

HYCBA series busbar adapters are hook-mounted and fixed. The hook is fixedly installed, and the busbar row does not need to be punched, which makes the installation more convenient, flexible and reliable. It can also realize the up and down, as well as the downward adjustment of the upper and lower, and facilitate the replacement and maintenance of the circuit breaker.

型号含义 Model meaning

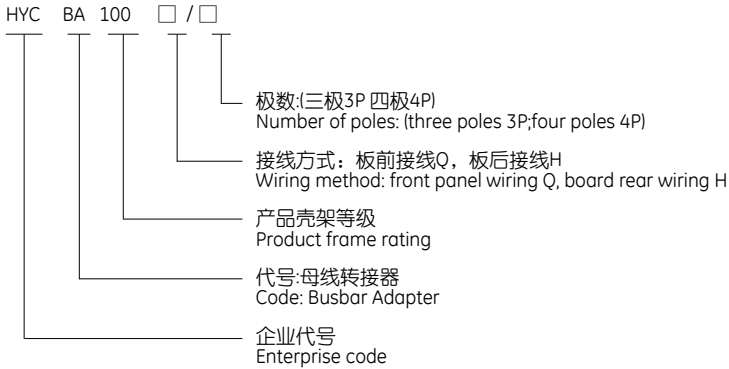

例：母线转接器100A板前接线3极 型号:HYCBA-100Q/3P

Eg: Busbar Adapter 100A Board Front Wiring 3 Poles Model: HYCBA-100Q/3P

技术参数（板前接线） Technical parameters (front wiring)

产品型号 Product model	产品外形尺寸 (A×B×H) Product dimensions	配断路器安装尺寸 E×(C,C1) With circuit breaker mounting dimensions	配断路器相间距(A) With circuit breaker phase spacing	高度差(h) Height difference	安装孔大小(M) Mounting hole size	附件Annex	
						铜管（镀 锡） Copper tube (tin plating)	螺钉（需带平垫） Screw (requires flat pad)
HYCBA-100H/3P	91×191×63	30×129	30	1.5	4	φ 12×φ 8.5×26	M8×45
HYCBA-100H/4P	122×248×63	60×129,60×199					
HYCBA-250H/3P	105×191×64	35×126	35	9	4	φ 14×φ 8.5×23	M8×45
HYCBA-250H/4P	142×253×64	70×126,70×201					
HYCBA-400H/3P	150×262×63	44×194	48	15.5	6	φ 18×φ 10.5×48.5	M10×70
HYCBA-400H/4P	198×303×63	94×194					
HYCBA-630H/3P	182×292×63	58×200	58	17	6	φ 22×φ 13×60.5	M10×92
HYCBA-630H/4P	240×292×63	116×200					

产品外形尺寸以及安装尺寸图 Product dimensions and installation dimensions

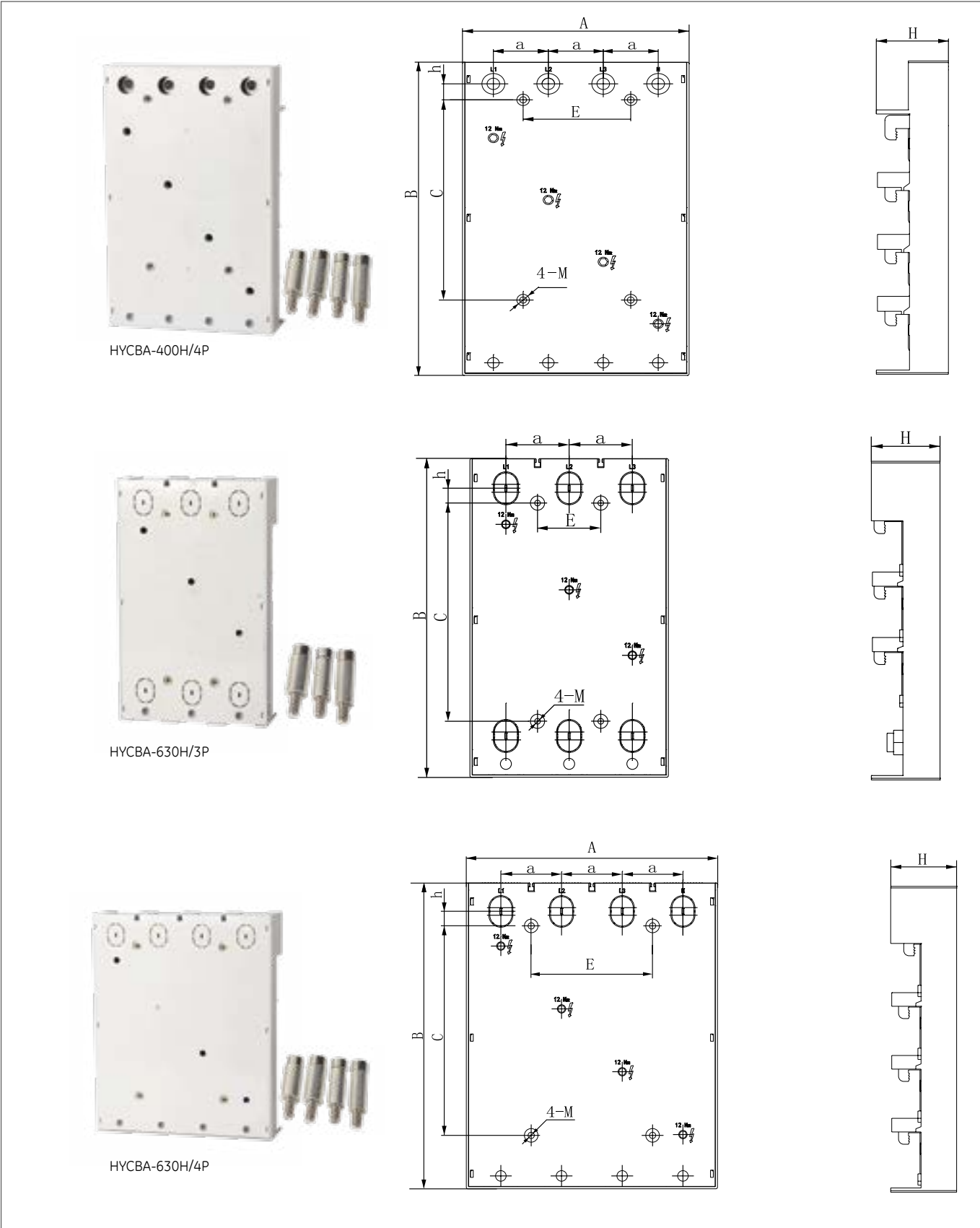
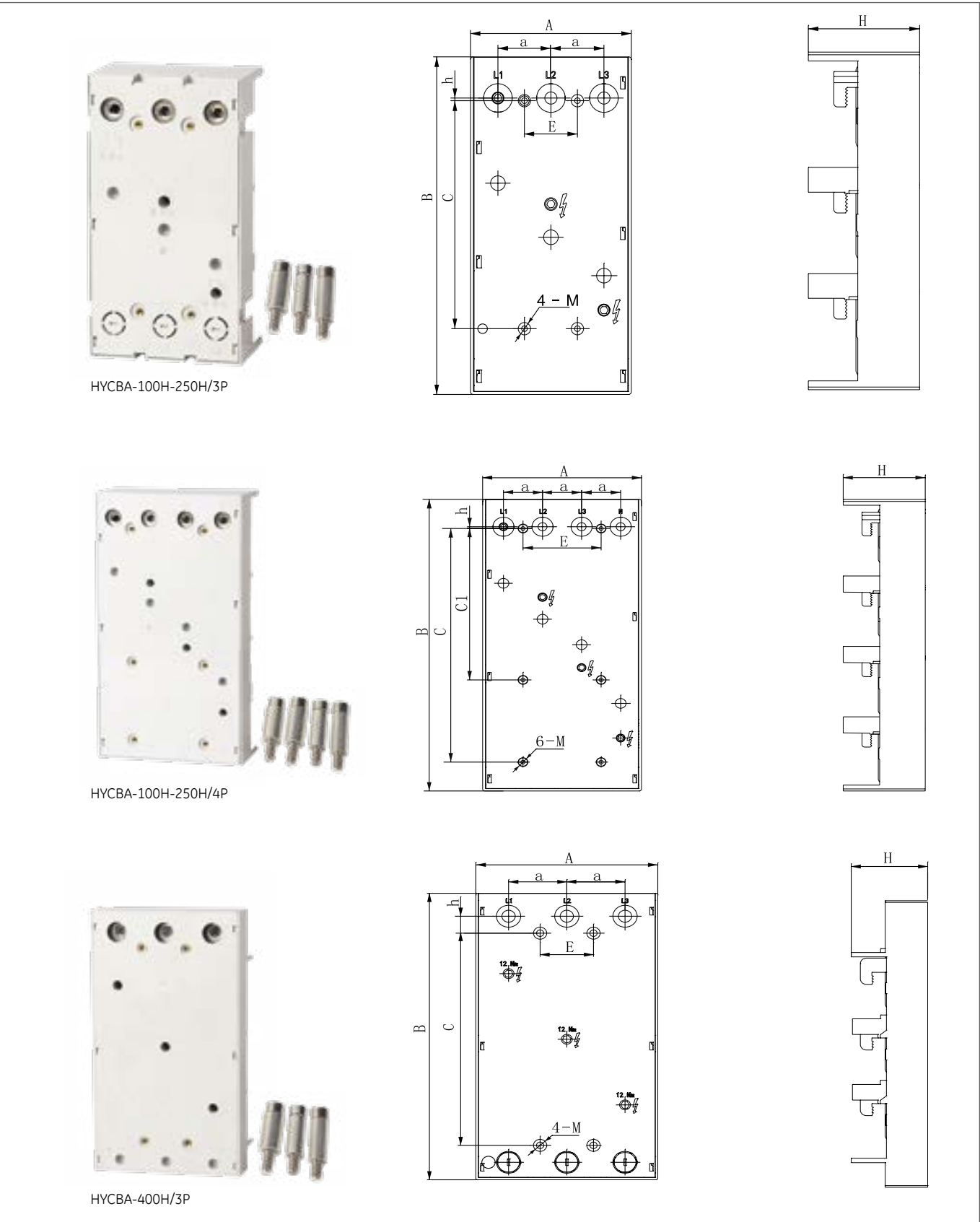

技术参数（板后接线） Technical parameters (post-board wiring)

产品型号 Product model	产品外形尺寸 (A × B × H) Product dimensions	产品安装尺寸 E × (C,C1,C2,C3) Product installation size	相间距(A) Phase spacing	安装孔大小(M) Mounting hole size	附件Annex 软铜排（镀锡） Soft copper row (tin plating)
HYCBA-100Q/3P	89 × 234 × 55	30 × (100,118,138,158)	30	4	2.5 × 15
HYCBA-100Q/4P	119 × 291 × 55				
HYCBA-250Q/3P	104 × 240 × 62.8	35 × (96,126,156)	35	4	3 × 18
HYCBA-250Q/4P	139 × 297 × 62.8				
HYCBA-400Q/3P	148 × 345 × 72.6	44.5 × (174,194,214)	48	6	5 × 30
HYCBA-630Q/3P	183 × 360 × 72.6	58 × (180,200,220)	58	6	6 × 30

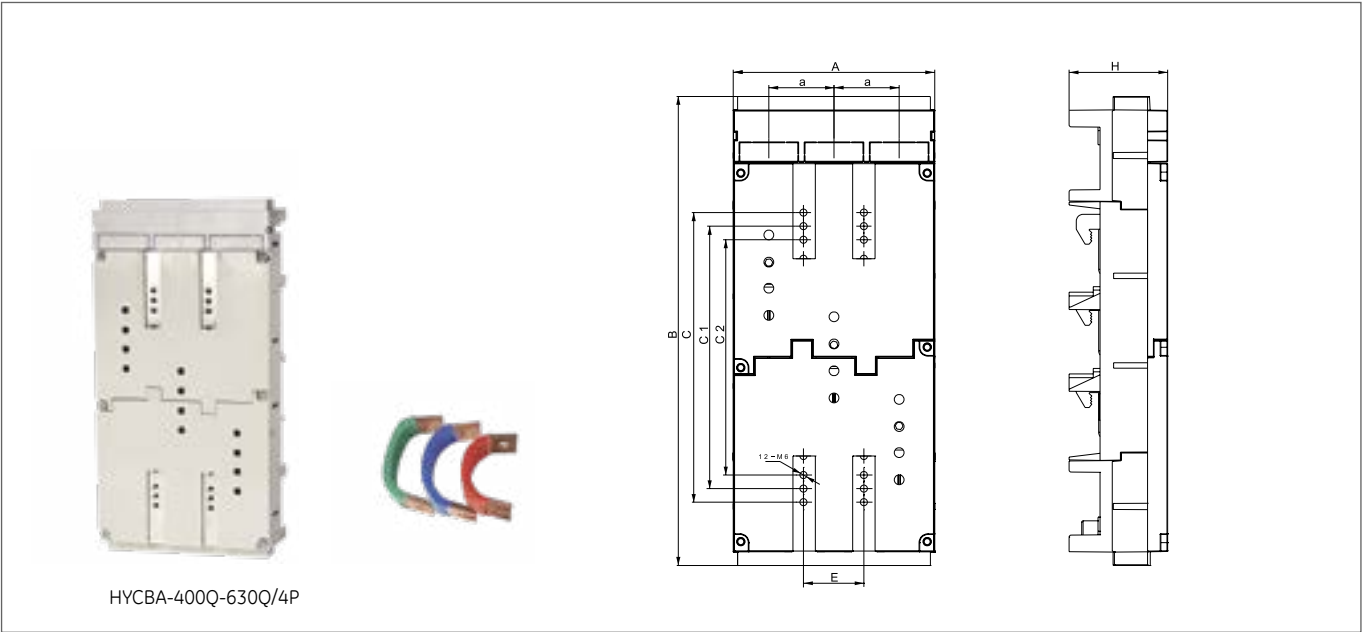
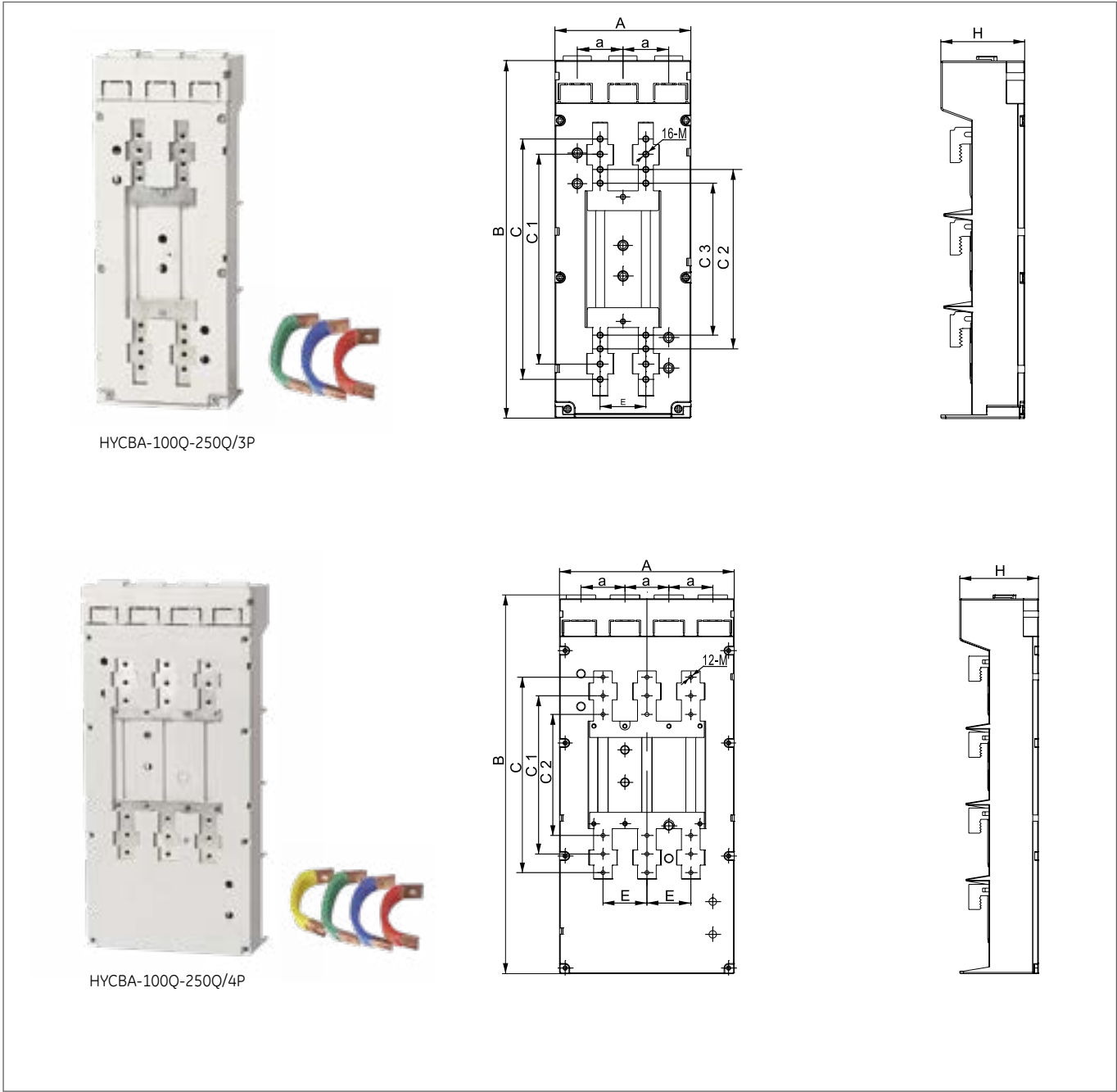

订货须知 Order notice

- 产品名称及型号；
 - 产品所匹配转接器与的断路器安装尺寸对应，并说明是上端连接还是下端连接（详情见下图）
- Product model and model number;
 - The adaptor matched by the product corresponds to the mounting size of the circuit breaker and indicates whether the upper end connection or the lower end connection (see the figure below for details).

